

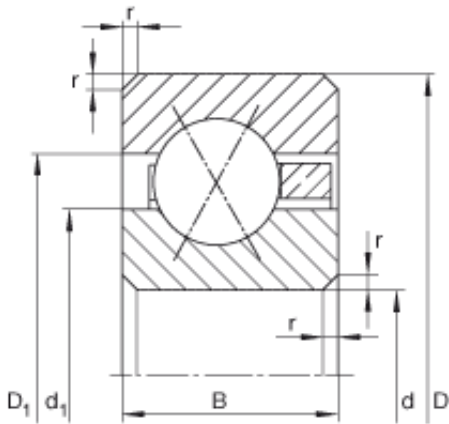

# S.J.N. Machinery Co., Ltd.

## 6 1/2 inch x 190,5 mm x 12,7 mm INA CSXD065 Deep groove ball bearings



CSXD065 Bearing 2D drawings and 3D CAD models

Bearing No. CSXD065

Size	165.1x190.5x12.7 mm
Bore Diameter	165,1 mm
Outer Diameter	190,5 mm
Width	12,7 mm
d	165,1 mm
d	6 1/2 inch
D	190,5 mm
B	12,7 mm
$D_1$	181,1 mm
$d_1$	174,5 mm
$r_{min}$	1,5 mm
m	0,55 kg / Weight
$C_r$	19500 N / Dynamic load rating (radial)
$C_{0r}$	33000 N / Static load rating (radial)
Category	Angular Contact Ball Bearings
Inventory	0.0
Manufacturer Name	SCHAEFFLER GROUP
Minimum Buy Quantity	N/A
Weight / Kilogram	0
EAN	4012802034356
Product Group	B04270
Enclosure	Open
Flush Ground	No



## SJN Machinery Co., Ltd.

Rolling Element	Ball Bearing
Number of Rows of Balls	Single Row
Precision Class	ABEC 1   ISO P0
Maximum Capacity / Filling Slot	No
Snap Ring	No
Cage Material	Brass
Contact Angle	35 Degree   4 Point
Internal Clearance	C0-Medium
Number of Bearings	1 (Single)
Inch - Metric	Inch
Long Description	6-1/2" Bore; 7-1/2" Outside Diameter; 1/2" Width; Open; No Flush Ground; Ball Bearing; Single Row of Balls; ABEC 1   ISO P0; No Filling Slot; No Snap Ring; C0-Medium; Brass Cage; 35 Deg
Other Features	Thin Section
Category	Angular Contact Ball Bearing
UNSPSC	31171531
Harmonized Tariff Code	8482.10.50.28
Noun	Bearing
Keyword String	Angular Contact
Manufacturer URL	<a href="http://www.ina.com">http://www.ina.com</a>
Weight / LBS	1.11
Bore	6.5 Inch   165.1 Millimeter
Width	0.5 Inch   12.7 Millimeter
Outside Diameter	7.5 Inch   190.5 Millimeter